

Valve Mounted Cylinder Double Acting, Single Rod

Series CVJ5

ø10, ø16

How to Order

Mounting style

B	Basic style
L	Axial foot style
F	Rod side flange style

Bore size

ø10	15, 30, 45, 60
ø16	15, 30, 45, 60

Stroke (mm)

10	10 mm
16	16 mm

Electrical entry

G	Grommet
L	L plug connector
M	M plug connector

Light/Surge voltage suppressor

Nil	Without light/surge voltage suppressor
S	With surge voltage suppressor
Z	With light/surge voltage suppressor
R	With surge voltage suppressor (No polarity)
U	With light/surge voltage suppressor (No polarity)

* Type "R", "U": DC only
* In the case of AC, since the rectifier prevents the production of surge voltage, there is no type "S".

CVJ5 L 16 - 60 - 5 L -

With auto switch CDVJ5 L 16 - 60 - 5 L - M9BW - C -

With auto switch (Built-in magnet)

Nil	Rod extended when energized
B	Rod retracted when energized

Solenoid valve voltage

DC specifications		AC specifications (50/60 Hz)	
S	24 VDC	1	100 VAC
6	12 VDC	2	200 VAC
V	6 VDC	3	110 VAC (115 VAC)
S	5 VDC	4	220 VAC (230 VAC)
R	3 VDC		

Built-in Magnet Cylinder Model

Suffix the symbol "A" (Rail mounting style) or "B" (Band mounting style) to the end of the w/ auto switch cylinder part number.

Example	Rail mounting style	CDVJ5B16-60-A
	Band mounting style	CDVJ5B10-45-B

Auto switch

Magnet installed even without auto switch

Symbol	Auto switch mounting
A	Rail mounting style
B	Band mounting style

Auto switch mounting bracket ^(Note)

Note) This symbol is indicated when the D-A9□ or M9□ type auto switch is specified. This mounting bracket does not apply to other auto switches (D-C7□ and H7□, etc.) (Nil)

Number of auto switches

Nil	2 pcs.
S	1 pc.
n	"n" pcs.

Made to Order
Refer to page 1703 for details.

* For the applicable auto switch model, refer to the table below.

Applicable Auto Switches/Refer to pages 1893 to 2007 for further information on auto switches.

Type	Special function	Electrical entry	Indicator light	Wiring (Output)	Load voltage		Auto switch model				Lead wire length (m)					Pre-wired connector	Applicable load
					DC	AC	Band mounting		Rail mounting		0.5 (Nil)	1 (M)	3 (L)	5 (Z)	None (N)		
							Perpendicular	In-line	Perpendicular	In-line							
Solid state auto switch	Diagnostic indication (2-color indication)	Grommet	Yes	3-wire (NPN)	24 V	5 V, 12 V	M9NV	M9N	—	—	●	●	○	○	○	IC circuit	
							—	F7NV	F79	●	●	○	○				
				M9PV			M9P	—	—	●	●	○	○				
		—		F7PV			F7P	●	●	○	○						
		M9BV		M9B			—	—	●	●	○	○					
		—		F7BV			J79	●	●	○	○						
	Water resistant (2-color indicator)	Grommet	No	3-wire (NPN)	24 V	5 V, 12 V	M9NWV	M9NW	—	—	●	●	○	○	○	IC circuit	
							—	F7NWV	F79W	●	●	○	○				
				M9PWV			M9PW	—	—	●	●	○	○				
		—		F7PW			—	—	●	●	○	○					
		M9BWW		M9BW			—	—	●	●	○	○					
		—		F7BWW			J79W	●	●	○	○						
With diagnostic output (2-color indication)	Grommet	Yes	3-wire (NPN)	24 V	5 V, 12 V	M9NAV ^{*1}	M9NA ^{*1}	—	—	○	○	●	○	○	IC circuit		
						M9PAV ^{*1}	M9PA ^{*1}	—	—	○	○	●	○	○			
			M9BAV ^{*1}			M9BA ^{*1}	—	—	○	○	●	○	○				
	—		H7NF			—	F79F	—	—	●	●	○	○				
	—		A96V			A96	—	A76H	—	—	●	●	○	○			
	—		200 V			—	A72	A72H	—	—	●	●	○	○			
Read auto switch	Grommet	No	2-wire	24 V	12 V	100 V	A93V ^{*2}	A93	A73	A73H	●	●	○	○	IC circuit		
						100 V or less	A90V	A90	A80	A80H	●	●	○	○			
						—	C73C	A73C	—	—	●	●	○	○			
	24 V or less					C80C	A80C	—	—	●	●	○	○				
	—					—	—	A79W	—	—	●	●	○	○			
	—					—	—	—	—	—	●	●	○	○			

* Lead wire length symbols: 0.5 m..... Nil (Example) M9NW
1 m..... M (Example) M9NWM
3 m..... L (Example) M9NWL
5 m..... Z (Example) M9NZZ

* Since there are other applicable auto switches than listed, refer to page 1711 for details.
* For details about auto switches with pre-wired connector, refer to pages 1960 and 1961.

* Solid state auto switches marked with "○" are produced upon receipt of order.
* D-A9□/M9□/A7□/A8□/F7□/J7□ auto switches are shipped together (not assembled). (For D-A9□/M9□, only auto switch mounting brackets are assembled before shipped.)
* D-C7□/C80□/H7□ auto switches are assembled at the time of shipment.
* Order auto switch mounting brackets separately when D-A9□(V)/M9□(V)/M9□(W(V))/M9□(A(V)) are mounted on ø10 and ø16 of the rail mounting type. Refer to page 1711 for details.
*1 Water resistant type auto switches can be mounted on the above models, but in such case SMC cannot guarantee water resistance. Consult with SMC regarding water resistant types with the above model numbers.
*2 1 m type lead wire is only applicable to D-A93.

Valve Mounted Cylinder Double Acting, Single Rod *Series CVJ5*

Operation type can be changed to rod extended when energized or rod retracted when energized.

An auto switch cylinder with the switch installed can also be manufactured.



Symbol

Double acting/Single rod, Rubber bumper

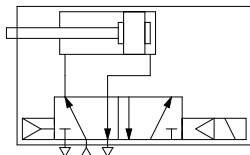

Made to Order Specifications
(For details, refer to pages 2009 to 2152.)

Symbol	Specifications
-XA□	Change of rod end shape

Specifications

Bore size (mm)	φ10	φ16
Action	Double acting, Single rod	
Fluid	Air	
Proof pressure	1.05 MPa	
Maximum operating pressure	0.7 MPa	
Minimum operating pressure	0.15 MPa	
Ambient and fluid temperature	-10 to 50°C (No freezing)	
Cushion	Rubber bumper	
Lubrication	Not required (Non-lube)	
Stroke length tolerance	$+1.0$ 0	
Port size	M5 x 0.8	
Mounting	Basic style, Axial foot style, Rod side flange style	
Piston speed	50 to 750 mm/s	50 to 150 mm/s
Allowable kinetic energy	0.035J	0.090J

Solenoid Valve Specifications

Applicable solenoid valve model		SYJ3190	
Electrical entry		Grommet (G), L plug connector (L), M plug connector (M)	
Coil rated voltage (V)	DC	24, 12, 6, 5, 3	
	AC 50/60 Hz	100, 110, 200, 220	
Effective area of valve (Cv factor)		1.8 mm ² (0.1)	
Allowable voltage		±10% of the rated voltage*	
Power consumption (W)	DC	Standard	0.35 (With indicator light: 0.4)
	AC	100 V	0.78 (With indicator light: 0.81)
110 V		0.86 (With indicator light: 0.89)	
[115 V]		[0.94 (With indicator light: 0.97)]	
200 V		1.18 (With indicator light: 1.22)	
220 V		1.30 (With indicator light: 1.34)	
[230 V]	[1.42 (With indicator light: 1.46)]		
Surge voltage suppressor		Diode (Varistor for the non-polar type)	
Indicator light		LED	

- * 110 VAC and 115 VAC types and 220 VAC and 230 VAC types are common respectively.
- * For 115 VAC and 230 VAC, allowable voltage fluctuation is -15 to +5 % of the rated voltage.
- * For S and Z, the voltage will drop due to the internal circuit. Allowable voltage fluctuation must be in the range below.
- Types S, Z 24 VDC: -7 to 10 %, 12 VDC: -4 to 10 %

Standard Stroke

Bore size (mm)	Standard stroke (mm)
10	15, 30, 45, 60
16	15, 30, 45, 60

- * If types for more than the strokes indicated in the table above (61 strokes) are required, please ask SMC.

CVQ

CVQM

CVJ□

CVM□

CVS3

CVS1

MVGQ

D-□

-X□

Series CVJ5

Mounting Style and Accessory For details, refer to page 1707.

Mounting		Basic style	Axial foot style	Rod side flange style
Standard equipment	Mounting nut	●	●	●
	Rod end nut	●	●	●
Option	Single knuckle joint	○	○	○
	Double knuckle joint (With pin)*	○	○	○

* Knuckle pin and retaining ring are shipped together. ●---Supplied with the product.
○---Please order separately.

Weight (g)

Bore size (mm)		10	16
Basic weight*		71	99
Additional weight per each 15 mm of stroke		6.5	9.5
Mounting bracket weight	Axial foot style	7	19
	Rod side flange style	5	13

* Mounting nut and rod end nut are included in the basic weight.

Calculation: (Example) **CVJ5L10-45-1G**

- Basic weight.....71 (g) (ø10)
 - Additional weight6.5/15 stroke
 - Cylinder stroked45 stroke
 - Weight of bracket7 (g) (Axial foot style)
- 71 + 6.5/15 x 45 + 7 = 97.5 g

Mounting Bracket Part No.

Mounting bracket	Bore size (mm)	
	10	16
Foot	CJ-L010B	CJ-L016B
Flange	CJ-F010B	CJ-F016B

Changing between Rod Extended when Energized and Rod Retracted when Energized

<Step>

This procedure is for changing the rod extended when energized to the rod retracted when energized.

- Using a screwdriver, loosen the two small round head screws, and remove the plate and the solenoid valve. At this time, instead of removing the plate and the solenoid valve separately, remove them together, with the round head screws remaining inserted.

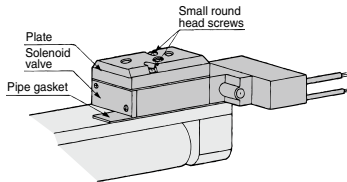

- Turn the pipe gasket at 180° and mount, showing the letter "B".

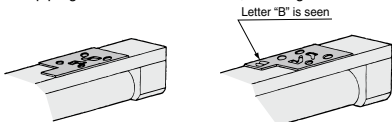

- Install the solenoid valve and the plate, and tighten the small round head screws, with a screw driver. After tightening, press the manual button on the solenoid valve, check for any air leaks, and verify the operating conditions. When the cylinder is viewed from above, the position of the gasket is as shown in the figure below.

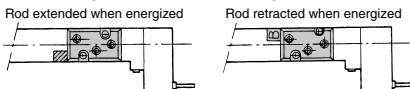

Manual Operation

Manual operation is possible by pushing the manual button indicated with the arrow.

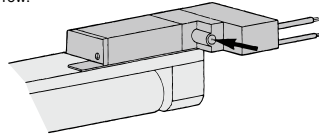

⚠ Specific Product Precautions

Be sure to read before handling. Refer to front matter 39 for Safety Instructions, pages 3 to 12 for Actuator and Auto Switch Precautions and 3/4/5 Port Solenoid Valve Precautions in Best Pneumatics No. 1.

Handling Precautions

⚠ Caution

- During installation, secure the rod cover and tighten the mounting nut or the rod cover body by applying an appropriate tightening force.

If the head cover is secured or the head cover is tightened, the cover may rotate, leading to the deviation.

- Tighten the mounting screws with an appropriate tightening torque within the range given below.

ø6: 2.1 to 2.5 N·m, ø10: 5.9 to 6.4 N·m

ø16: 10.8 to 11.8 N·m

- To remove and install the retaining ring for the knuckle pin or the clevis pin, use an appropriate pair of pliers (tool for installing a type C retaining ring).

In particular, use a pair of ultra-mini pliers for removing and installing the retaining rings on the ø10 cylinder.

- For the auto switch mounting rail, do not remove the pre-equipped rail.

Since the mounting thread is drilled through inside the cylinder, it may cause air leakage.

⚠ Warning

- Confirm the specifications.

Products in this catalog are designed to be used for compressed air systems. If not operated within the designated pressure or temperature, it may damage the products or cause malfunction. (Refer to specifications.)

- Energizing continuously for a long period of time

When the valve is continuously energized for a long period of time, the performance may deteriorate, shorten the service life or effect peripheral equipment adversely since temperature rises when coils generate heat.

Series CVJ5

Axial Foot Style (L)

CVJ5L

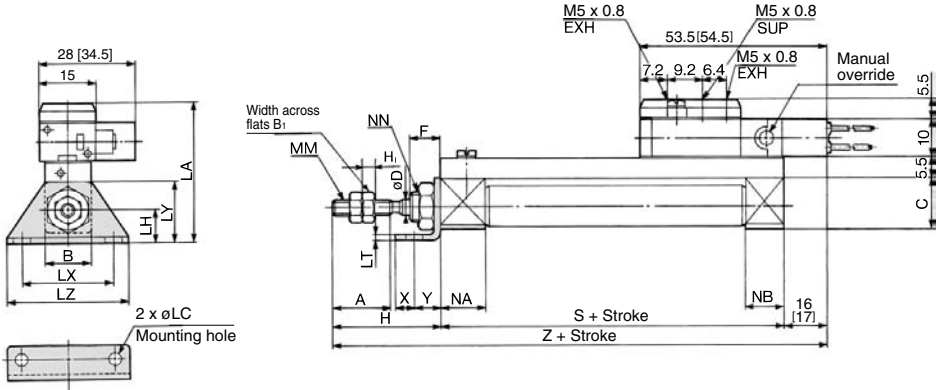

Rod End Nut

Bore size (mm)	B ₁	H ₁
10	7	3.2
16	8	4

* []: Denotes the values of AC.

Bore size	A	B	C	D	F	H	LA	LC	LH	LT	LX	LY	LZ	MM	NA	NB	NN	S	X	Y	Z
10	15	12	14	4	8	28	38	4.5	9	1.6	24	16.5	32	M4 x 0.7	12.5	9.5	M8 x 1	46	5	7	90 [91]
16	15	18	20	5	8	28	46	5.5	14	2.3	33	25	42	M5 x 0.8	12.5	9.5	M10 x 1	47	6	9	91 [92]

Rod Side Flange Style (F)

CVJ5F

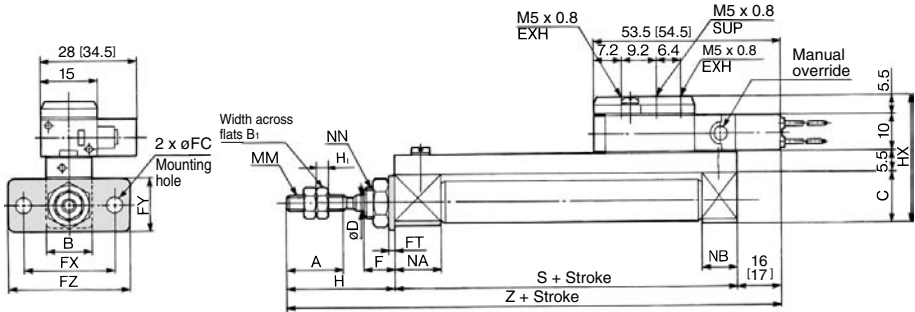

Rod End Nut

Bore size (mm)	B ₁	H ₁
10	7	3.2
16	8	4

* []: Denotes the values of AC.

Bore size	A	B	C	D	F	FC	FT	FX	FY	FZ	H	HX	MM	NA	NB	NN	S	X	Y	Z
10	15	12	14	4	8	4.5	1.6	24	14	32	28	35	M4 x 0.7	12.5	9.5	M8 x 1	46	5	7	90 [91]
16	15	18	20	5	8	5.5	2.3	33	20	42	28	41	M5 x 0.8	12.5	9.5	M10 x 1	47	6	9	91 [92]

Series CVJ5

Accessory Dimensions

Single Knuckle Joint

(mm)

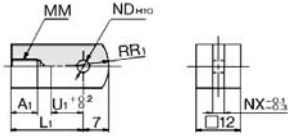

Material: Rolled steel

Part no.	Applicable bore size	A ₁	L ₁	MM	ND ^{H10}	NX	R ₁	U ₁
I-J010B	10	8	21	M4 x 0.7	3.3 ^{+0.048} ₀	3.1	8	9
I-J016B	16	8	25	M5 x 0.8	5 ^{+0.048} ₀	6.4	12	14

Knuckle Pin

(mm)

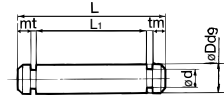

Material: Stainless steel

Part no.	Applicable bore size	Dd9	d	L	L ₁	m	t	Applicable retaining ring
IY-J010	10	3.3 ^{-0.030} _{-0.060}	3	16.2	12.2	1.7	0.3	Type C 3.2
IY-J015	16	5 ^{-0.030} _{-0.060}	4.8	16.6	12.2	1.5	0.7	Type C 5

* Retaining rings are included.

Double Knuckle Joint

(mm)

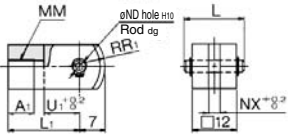

Material: Rolled steel

Part no.	Applicable bore size	A ₁	L	L ₁	MM	ND ₀₉	ND ^{H10}	NX	R ₁	U ₁
Y-J010B	10	8	16.2	21	M4 x 0.7	3.3 ^{-0.030} _{-0.060}	3.3 ^{+0.048} ₀	3.2	8	10
Y-J016B	16	11	16.6	21	M5 x 0.8	5 ^{-0.030} _{-0.060}	5 ^{+0.048} ₀	6.5	12	10

* Knuckle pin and retaining ring are shipped together.

Mounting Nut

(mm)

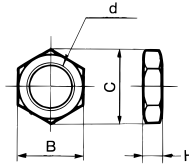

Material: Brass

Part no.	Applicable bore size	B	C	d	H
SNJ-010B	10	11	12.7	M8 x 1.0	4
SNJ-016B	16	14	16.2	M10 x 1.0	4

Rod End Nut

(mm)

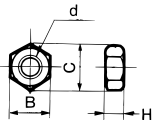

Material: Iron

Part no.	Applicable bore size	B	C	d	H
NTJ-010A	10	7	8.1	M4 x 0.7	3.2
NTJ-015A	16	8	9.2	M5 x 0.8	4

CVQ

CVQM

CVJ

CVM

CV3

CVS1

MVGQ

D-

-X

Auto Switch Mounting 1

Auto Switch Proper Mounting Position (Detection at Stroke End) and Its Mounting Height

Reed auto switch

<Band mounting>

D-A9□

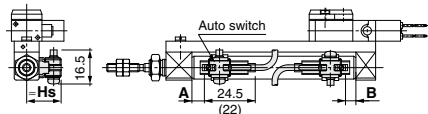

() : For D-A96 type
A and B are the dimensions from the end of the head cover/rod cover to the end of the auto switch.

D-C7□/C80

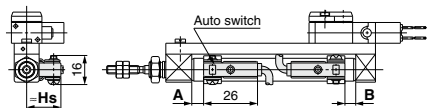

D-C73C□/C80C

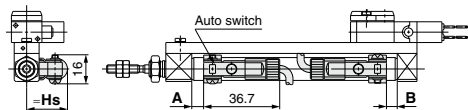

<Rail mounting>

D-A9□

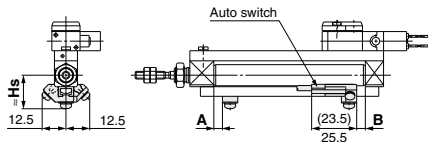

() : For D-A96 type

D-A9□V

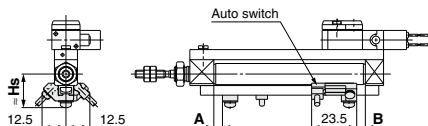

D-A7□/A80

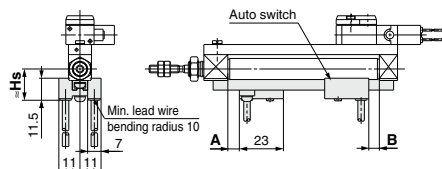

D-A7□H/A80H

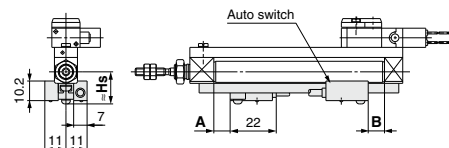

D-A73C/A80C

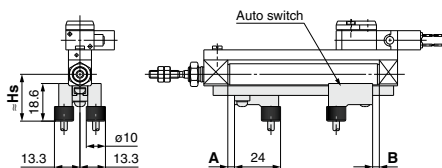

D-A79W

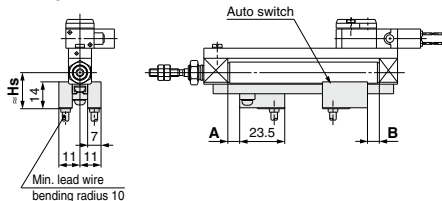

Auto Switch Proper Mounting Position (Detection at Stroke End) and Its Mounting Height

Solid state auto switch

<Band mounting>

D-M9□
D-M9□W

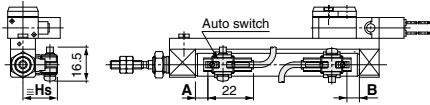

D-H7□
D-H7□W
D-H7NF

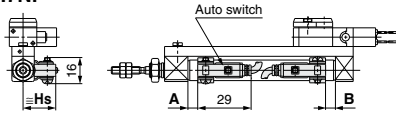

D-H7C

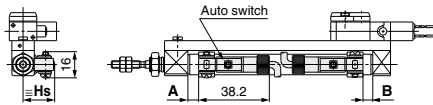

<Rail mounting>

D-M9□
D-M9□W

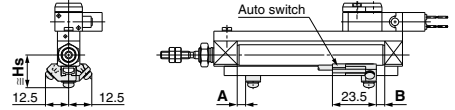

D-M9□V
D-M9□WV

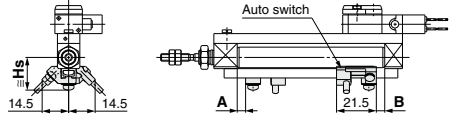

D-F7□/J79
D-F7□W/J79W
D-F79F

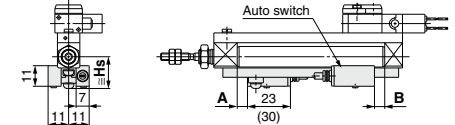

D-F7□V/F7□WV

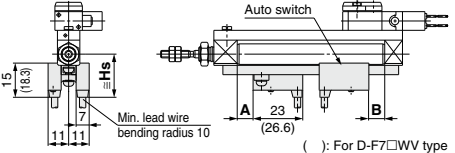

D-J79C

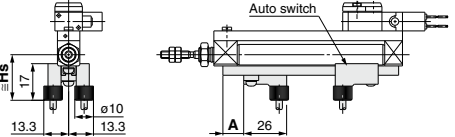

Auto Switch Proper Mounting Position

Auto switch model	Band mounting										Rail mounting										
	D-A9□ D-A9□V		D-M9□ D-M9□W D-M9□WV D-M9□A D-M9□AW		D-C7□ D-C80 D-C73C D-C80C		D-H7□ D-H7NF D-H7□W		D-A9□ D-A9□V		D-M9□ D-M9□V D-M9□W D-M9□WV D-M9□AV		D-A7□ D-A80		D-A7□/H/A80H D-A73C/A80C D-F7□/J79 D-F7□W/J79W D-F79F/J79C		D-F7NT		D-A79W		
	A	B	A	B	A	B	A	B	A	B	A	B	A	B	A	B	A	B	A	B	
Bore size (mm)	10	2	2	6	6	2.5	2.5	1.5	1.5	0.5	0.5	4.5	4.5	3	3	3.5	3.5	8.5	8.5	0.5	0.5
	16	2.5	2.5	6.5	6.5	3	3	2	2	1	1	4	4	3.5	3.5	4	4	9	9	1	1

Note) Adjust the auto switch after confirming the operating conditions in the actual setting.

Auto Switch Mounting Height

Auto switch model	Band mounting					Rail mounting						
	D-A9□ D-M9□ D-M9□W D-M9□A	D-M9□V D-M9□WV D-M9□AV D-A9□V	D-C7□/C80 D-H7□/H7□W D-H7NF	D-C73C D-C80C	D-H7C	D-A9□/A9□V D-M8□/M8□V D-M9□W D-M9□WV	D-A7□ D-A80	D-A7□/H/A80H D-F7□/J79 D-F7□W/J79W D-F79F	D-A73C D-A80C	D-F7□V D-F7□WV	D-J79C	D-A79W
Bore size (mm)	Hs	Hs	Hs	Hs	Hs	Hs	Hs	Hs	Hs	Hs	Hs	Hs
10	17	18	17	19.5	20	17.5	16.5	17.5	23.5	20	23	19
16	20.5	21	20.5	23	23.5	21	19.5	20.5	26.5	23	26	22

CVQ

CVQM

CVJ□

CVM□

CV3

CVS1

MVGQ

D-□

-X□

Auto Switch Mounting 2

Minimum Auto Switch Mounting Stroke

		(mm)				
Auto switch mounting	Auto switch model	No. of auto switches mounted				
		1	2		n (n: No. of auto switches)	
			Different surfaces	Same surface	Different surfaces	Same surface
Band mounting	D-M9□/M9□W D-A9□/M9□A	10	15 ^{Note 1)}	45 ^{Note 1)}	$15 + 35 \frac{(n-2)}{2}$ (n = 2, 4, 6...) ^{Note 4)}	$45 + 15 (n-2)$ (n = 2, 3, 4, 5...)
	D-M9□V	5	15 ^{Note 1)}	35	$15 + 35 \frac{(n-2)}{2}$ (n = 2, 4, 6...) ^{Note 4)}	$35 + 25 (n-2)$ (n = 2, 3, 4, 5...)
	D-M9□WV D-M9□AV	10	15 ^{Note 1)}	35	$15 + 35 \frac{(n-2)}{2}$ (n = 2, 4, 6...) ^{Note 4)}	$35 + 25 (n-2)$ (n = 2, 3, 4, 5...)
	D-A9□V	5	10	35	$10 + 35 \frac{(n-2)}{2}$ (n = 2, 4, 6...) ^{Note 4)}	$35 + 25 (n-2)$ (n = 2, 3, 4, 5...)
	D-C7□ D-C80	10	15	50	$15 + 40 \frac{(n-2)}{2}$ (n = 2, 4, 6...) ^{Note 4)}	$50 + 20 (n-2)$ (n = 2, 3, 4, 5...)
	D-H7□ D-H7□W D-H7NF	10	15	60	$15 + 45 \frac{(n-2)}{2}$ (n = 2, 4, 6...) ^{Note 4)}	$60 + 22.5 (n-2)$ (n = 2, 3, 4, 5...)
	D-C73C D-C80C D-H7C	10	15	65 ^{Note 2)}	$15 + 50 \frac{(n-2)}{2}$ (n = 2, 4, 6...) ^{Note 4)}	$50 + 27.5 (n-2)$ (n = 2, 3, 4, 5...)
	Rail mounting	D-M9□V	5	—	5	—
D-A9□V		5	—	10	—	$10 + 15 (n-2)$ (n = 4, 6...) ^{Note 5)}
D-M9□ D-A9□		10	—	10	—	$15 + 15 (n-2)$ (n = 4, 6...) ^{Note 5)}
D-M9□WV D-M9□AV		10	—	15	—	$15 + 15 (n-2)$ (n = 4, 6...) ^{Note 5)}
D-M9□W		15	—	15	—	$20 + 15 (n-2)$ (n = 4, 6...) ^{Note 5)}
D-M9□A		15	—	20	—	$20 + 15 (n-2)$ (n = 4, 6...) ^{Note 5)}
D-A7□/A80 D-A7□H/A80H D-A73C/A80C		5	—	10	—	$15 + 10 (n-2)$ (n = 4, 6...) ^{Note 5)}
D-A7□H D-A80H		5	—	10	—	$15 + 15 (n-2)$ (n = 4, 6...) ^{Note 5)}
D-A79W		10	—	15	—	$10 + 15 (n-2)$ (n = 4, 6...) ^{Note 5)}
D-F7□ D-J79		5	—	5	—	$15 + 15 (n-2)$ (n = 4, 6...) ^{Note 5)}
D-F7□V D-J79C		5	—	5	—	$10 + 10 (n-2)$ (n = 4, 6...) ^{Note 5)}
D-F7□W/J79W D-F79F/F7NT		10	—	15	—	$15 + 20 (n-2)$ (n = 4, 6...) ^{Note 5)}
D-F7□WV		10	—	15	—	$10 + 15 (n-2)$ (n = 4, 6...) ^{Note 5)}

Note 4) When "n" is an odd number, an even number that is one larger than this odd number is used for the calculation.
 Note 5) When "n" is an odd number, an even number that is one larger than this odd number is used for the calculation.
 However, the minimum even number is 4. So, 4 is used for the calculation when "n" is 1 to 3.

Note 1) Auto switch mounting (The adjustment as shown in the figures below is required with the following stroke ranges.)

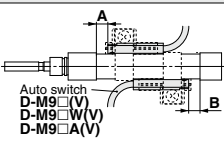
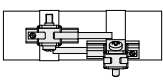
Auto switch model	With 2 auto switches	
	Different surfaces ^{Note 1)}	Same surface ^{Note 1)}
	 <p>The proper auto switch mounting position is 5.5 mm inward from the switch holder edge.</p>	 <p>The auto switch is mounted by slightly displacing it in a direction (cylinder tube circumferential exterior) so that the auto switch and lead wire do not interfere with each other.</p>
D-A93	—	45 to less than 50 stroke
D-M9□ D-M9□W	15 to less than 20 stroke	45 to less than 55 stroke

Note 2) For Series CDVJ5, note that 65 strokes cannot be manufactured.

Note 3) The dimension stated in () shows the minimum stroke for the auto switch mounting when the auto switch does not project from the end surface of the cylinder body and hinder the lead wire bending space. (Refer to the figure below.)

These contents apply to the rail mounting with one or two auto switches.

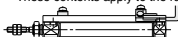

Operating Range

Auto switch model	Bore size (mm)	
	10	16
D-A9□(V)	6	7
D-M9□(V)	2.5	3
D-M9□W(V)/M9□A(V)		
D-C7□/C80/C73C/C80C	7	7
D-H7□/H7□W/H7NF	4	4
D-H7C	8	9

* Since the operating range is provided as a guideline including hysteresis, it cannot be guaranteed (assuming approximately ±30% dispersion). It may vary substantially depending on an ambient environment.

Auto switch model	Bore size (mm)	
	10	16
D-A9□/A9□V	6	6.5
D-M9□/M9□V	3	3.5
D-M9□W/M9□WV		
D-M9□A/M9□AV		
D-A7□/A80/A7H/A80H/A73C/A80C	8	9
D-A79W	11	13
D-F7□/J79/F7□W/J79W	5	5
D-F7□V/F7□WV/F79F/J79C		
D-F7NT		

Auto Switch Mounting Bracket: Part No.

Auto switch mounting	Auto switch model	Bore size (mm)	
		ø10	ø16
Band mounting	D-M9□ D-M9□V D-M9□WV D-M9□W D-A9□ D-A9□V	BJ6-010 Note 1)	BJ6-016 Note 1)
	D-M9□A D-M9□AV	BJ6-010S Note 2)	BJ6-016S Note 2)
Band mounting		(1) BJ2-□□□ is a set of "a" and "b". (2) BJ□-1 is a set of "c" and "d". BJ4-1 (Switch bracket: White) BJ5-1 (Switch bracket: Transparent)	
		D-C7□/C80 D-C73C/C80C D-H7□/H7□W D-H7NF	BJ2-010
Rail mounting	D-A9□ D-A9□V D-M9□ D-M9□V D-M9□W D-M9□WV D-M9□A D-M9□AV	BQ2-012 Note 5)	BQ2-012 Note 5)

Note 1) Set part number which includes the auto switch mounting band (BJ2-□□□) and the holder kit (BJ5-1/Switch bracket: Transparent). Since the switch bracket (made from nylon) are affected in an environment where alcohol, chloroform, methylamines, hydrochloric acid or sulfuric acid is splashed over, so it cannot be used. Please consult SMC regarding other chemicals.

Note 2) Set part number which includes the auto switch mounting band (BJ2-□□□S) and the holder kit (BJ4-1/Switch bracket: White).

Note 3) For the D-M9□A (V) type auto switch, do not install the switch bracket on the indicator light.

Note 4) Only auto switch mounting brackets are assembled when cylinders are shipped.

Note 5) When a compact auto switch is mounted on the rail mounting type, the auto switch mounting brackets on the left are required. Order them separately from cylinders.

Example order: CDJ2B10-60-A 1 unit
 D-M9BWV 2 pcs.
 BQ2-012 2 pcs.

Besides the models listed in How to Order, the following auto switches are applicable. Refer to pages 1893 to 2007 for detailed specifications.

Auto switch type	Part no.	Electrical entry (Fetching direction)	Features
Reed	D-C73, C76	Grommet (In-let)	—
	D-C80		Without indicator light
Solid state	D-H7A1, H7A2, H7B		—
	D-H7NW, H7PW, H7BW		Diagnostic indication (2-color)

* For solid state auto switches, auto switches with a pre-wired connector are also available. Refer to pages 1960 and 1961 for details.

* Normally closed (NC = b contact) solid state auto switches (D-F9G/F9H types) are also available. Refer to page 1911 for details.